

VEHICLE INSTALLATION INSTRUCTIONS  
 CHEV/GMC 4 X 2: 1991-2002  
 3500 HD CHASSIS CAB

Hiniker Company  
 58766 240th St.  
 P.O. BOX 3407  
 Mankato, MN 56002

INSTRUCTION SHEET NO: 25010595 REV. A

November 8, 2005

**IMPORTANT: Read the Snowplow Operator's Manual before assembling this kit.**

MINIMUM VEHICLE RECOMMENDATIONS	REAR BALLAST - As required to meet front GAWR
Standard Equipment	

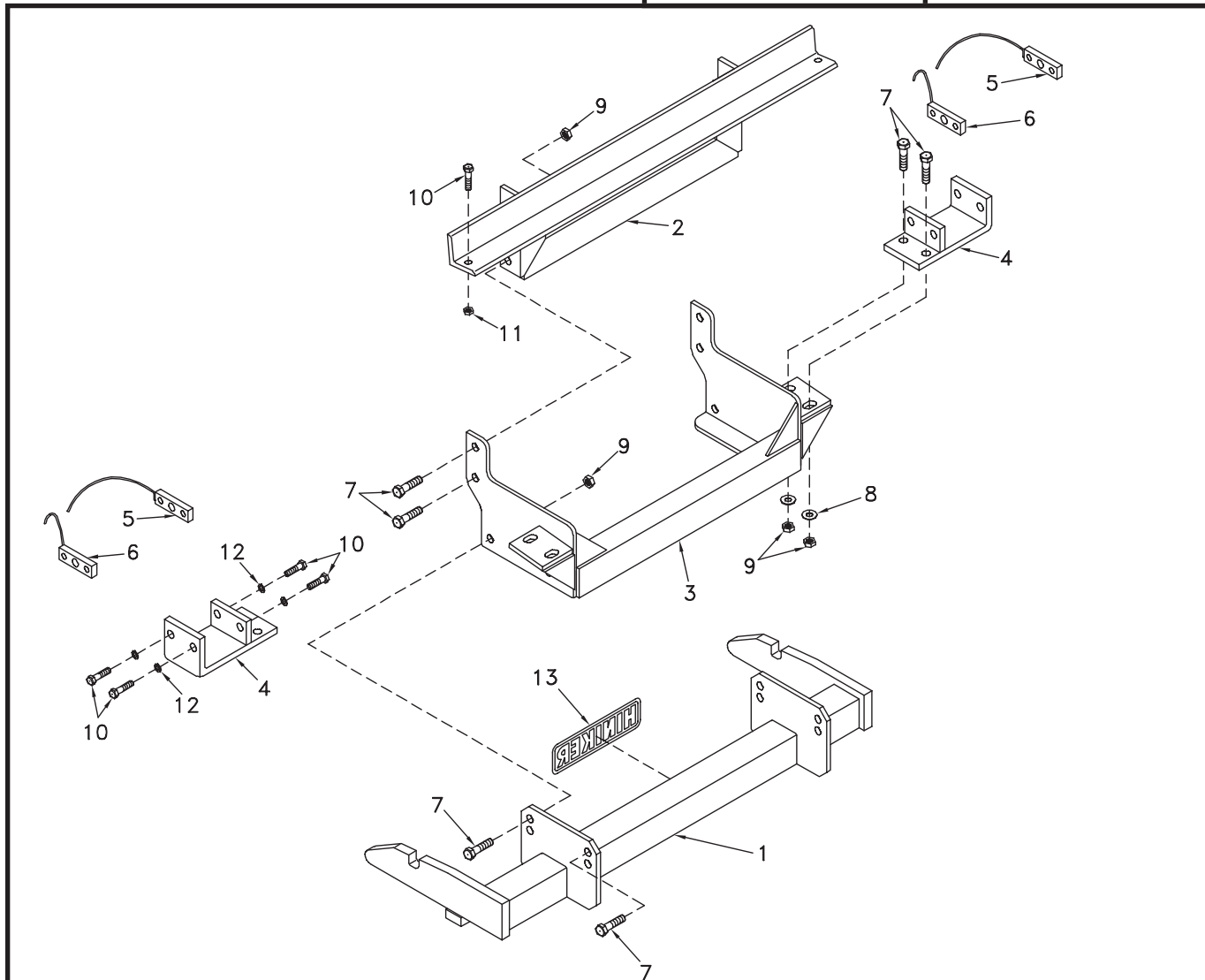

Mount Kit No. 25010534

DWG NO. 3567A

REF. NO.	PART NUMBER	DESCRIPTION	QTY.	REF. NO.	PART NUMBER	DESCRIPTION	QTY.
1	25010593	Prong Weldment	1	8	952-003-003	SAE Flat Washer, 5/8 Inch	4
2	25010591	Front Frame Weldment	1	9	060756	Lock Nut 5/8-11 Nylon Insert	12
3	25010582	Mount Frame Weldment	1	10	950-001-125	Hex Head Cap Screw 1/2-13 X 1 1/2 Gr. 5	10
4	25010586	Rear Bracket Weldment	2	11	951-003-009	Lock Nut 1/2-13 Nylon Insert	2
5	25010173	RH Nut Weldment	2	12	952-001-004	Lock Washer, 1/2 Inch	8
6	25010174	LH Nut Weldment	2	13	25010008	Hiniker Decal	1
7	950-001-132	Hex Head Cap Screw 5/8-11 X 1 3/4 Gr. 5	12		25011165	Bolt Bag	1

All hardware should be tightened only enough to ensure safety during assembly. Fully tighten all hardware after entire assembly is completed.

**GRADE 5 TYPE B & F LOCK NUT TORQUES**

Size	Ft-lbs.	N-m
5/16"	13-18	17-25
3/8"	23-33	31-44
1/2"	58-82	79-112
5/8"	117-165	158-223

**GRADE 5 BOLT TORQUES\***

Size	Ft-lbs.	N-m
1/4"	8-12	11-16
3/8"	29-41	39-56
1/2"	73-103	99-140
5/8"	146-206	198-279

\* applications without lock nuts

1. Remove the grill, front bumper and bumper brackets from the vehicle. Retain hardware for reinstallation.
2. Place the front frame weldment across the top of the vehicle rails and pull tight against the back of the rail end members.

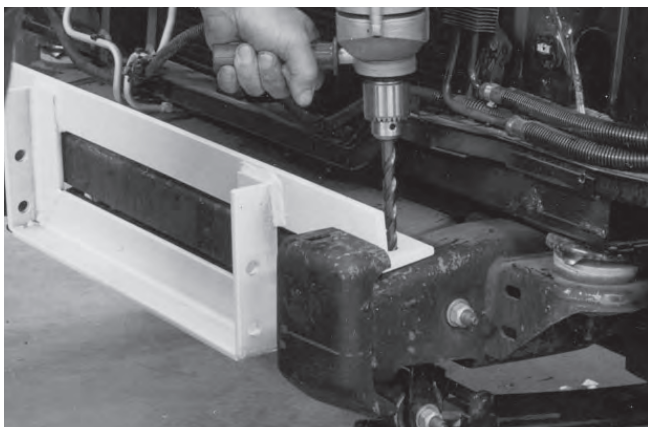

PHOTO NO. 3763

Center the frame between the vehicle rails, then drill a 17/32 inch diameter hole into the top of each rail through the holes in the front frame.

Fasten the frame to the vehicle with 1/2 inch X 1 1/2 inch hex bolts and lock nuts.

3. Loosely bolt the top holes at the front of the mount frame weldment to the top holes in the front frame weldment with 5/8 inch X 1 3/4 inch hex bolts and lock nuts.

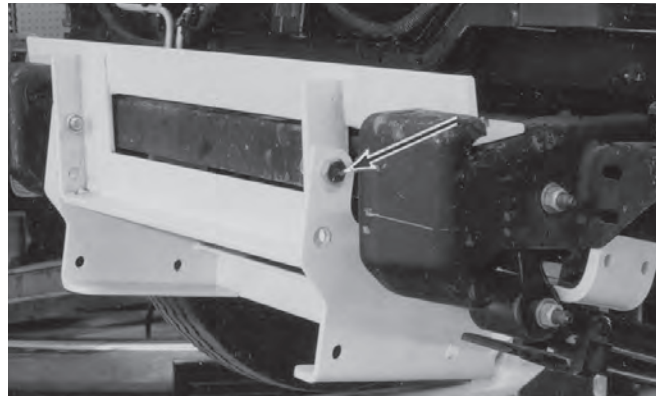

PHOTO NO. 3764

Assemble the rear bracket weldments to holes at the back of the mount frame weldment with 5/8 inch X 1 3/4 inch hex bolts, flat washers and lock nuts.

Rotate the mount frame up until the rear brackets are tight against the bottom of the vehicle rails inside the vehicle body mount brackets.

Loosely install lower bolts between the front frame weldment and the mount frame to hold in place.

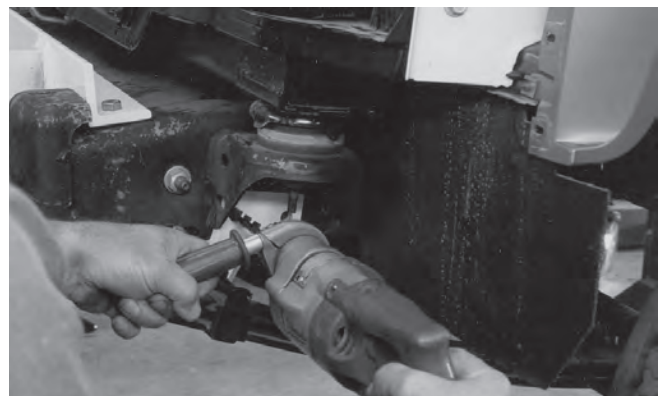

PHOTO NO. 3765

Ensure that the rear brackets are tight to the bottom of the vehicle rails before drilling two 17/32 inch diameter holes into each rail through the outer sets of holes in the rear bracket weldments.

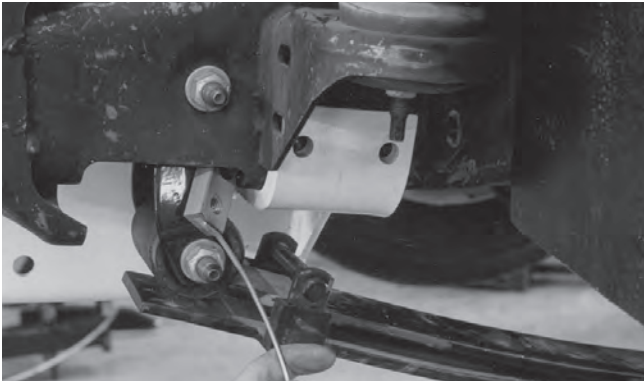

PHOTO NO. 3766

Insert a nut bar weldment into the vehicle rail and fasten rear brackets with 1/2 inch x 1 1/2 inch hex bolts and lock washers.

Remove the mount frame weldment and drill 17/32 inch diameter holes into the vehicle through the inner sets of holes in the rear brackets.

Insert nut bars into the vehicle rails and secure with 1/2 inch X 1 1/2 inch hex bolts and lock washers.

4. Reinstall the mount frame weldment between the front frame weldment and the rear brackets with 5/8 inch X 1 3/4 inch hex bolts.

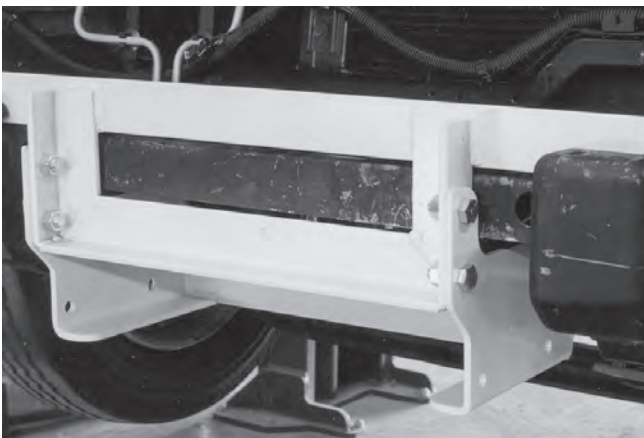

PHOTO NO. 3767

5. Fasten the mount plates of the prong weldment to holes in the mount frame with four 5/8 inch X 1 3/4 inch hex bolts and lock nuts.

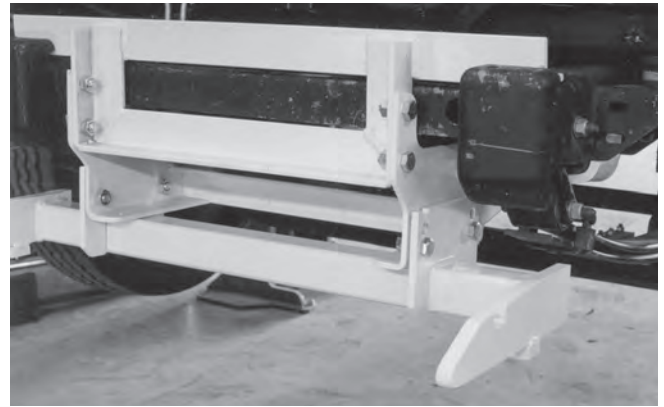

PHOTO NO. 3768

Bottom edges of the prongs should measure about 10 inches above the ground. Ideally, the prongs should lift the plow frame slightly when driving into the plow.

6. Fully tighten all hardware to specified torques.
7. Reinstall the front bumper, bumper brackets and grill onto the vehicle with original hardware.